



MEMORANDUM

TO: Board of Park Commissioners

THROUGH: Shon Sylvia, Executive Director

FROM: Mary Stump, Deputy Director of Planning
Debbie Terwilleger, Director of Business Administration and Planning

SUBJECT: Approving Two Easements from City of Tacoma at Melanie La Plant Dressel Park for the Ability to Install, Construct, Operate, Inspect, Maintain, Remove, Repair or Replace Easement Improvements

DATE: February 16, 2021

EXECUTIVE SUMMARY: Approval of a resolution is requested granting an easement to Metro Parks Tacoma from the City of Tacoma and authorizing the Executive Director to negotiate and sign said easement.

CAPITAL IMPROVEMENT COMMITTEE RECOMMENDATION: This resolution was reviewed by the Capital Improvement Committee at their meeting on February 10, 2021 and through follow up correspondence, with a recommendation to forward the action on to the full Board for approval.

BACKGROUND: In 2020 Metro Parks acquired property on the Thea Foss Waterway for the development of Melaine La Plant Dressel Park. In order to make planned park improvements, two easements were needed to be requested from the City of Tacoma on property abutting the north property boundary of Melanie La Plant Dressel Park. This request is to provide a non-exclusive perpetual easement to install, construct, operate, inspect, maintain, remove, repair, and replace park and sewer system improvements (Easement Improvements). This work should minimally impact the site and the City will provide routine operation and maintenance on the sewer under the terms of this agreement.

The Easement Area is as described within City of Tacoma Easement No. 4526

FISCAL IMPACT: There is no dollar value attached to the granting of this easement.

ADDITIONAL INFORMATION: For additional information, please contact Debbie Terwilleger, Director of Business Administration and Planning at (253) 305-1086 or Marty Stump, Deputy Director of Planning at (253)-305-1078.

METROPOLITAN PARK DISTRICT OF TACOMA

RESOLUTION NO. R18-21

**APPROVING TWO EASEMENTS FROM CITY OF TACOMA AT
MELANIE LA PLANT DRESSEL PARK FOR THE ABILITY TO INSTALL,
CONSTRUCT, OPERATE, INSPECT, MAINTAIN, REMOVE, REPAIR OR
REPLACE EASEMENT IMPROVEMENTS**

WHEREAS, the Board of Park Commissioners of the Metropolitan Park District of Tacoma desires to construct improvements to Melanie La Plant Dressel Park; and

WHEREAS, in order to complete said improvements Metro Parks Tacoma requires additional park space and the construction of a sewer line (Easement Improvements) on City of Tacoma property adjacent to the park property; and

WHEREAS; the proposed easement permits the Metro Parks to install, construct, operate, inspect, maintain, remove, repair and replace the Easement Improvements; Now, therefore, be it

RESOLVED by the Board of Park Commissioners of the Metropolitan Park District of Tacoma to approve the granting of park and utility easements described within City of Tacoma Easement No. 4526 and as shown on EXHIBITS 'A' and 'B', and that the Executive Director be authorized to negotiate and sign said easement on behalf of the Board.

The foregoing resolution was adopted by the Board of Park Commissioners of the Metropolitan Park District of Tacoma at a regular meeting held on Feb 22 2021.

DocuSigned by:

595F33BFD2F2441...

President

ATTEST:

Secretary

DocuSigned by:

54EC44E8D94544C...

Clerk

EXHIBIT "A"

City of Tacoma Property

THE SOUTH HALF OF LOT 12, ALL OF LOTS 13 AND 14, AND THE NORTH HALF OF LOT 15, BLOCK 62, ACCORDING TO THE OFFICIAL MAP OF TACOMA TIDELANDS, FILED IN THE OFFICE OF THE COMMISSIONER OF PUBLIC LANDS AT OLYMPIA, WASHINGTON SEPTEMBER 3, 1895.

ALL SITUATE IN THE SOUTHEAST QUARTER OF THE NORTHWEST QUARTER OF SECTION 04, TOWNSHIP 20 NORTH, RANGE 03 EAST OF THE W.M., WITHIN THE CITY OF TACOMA, COUNTY OF PIERCE, STATE OF WASHINGTON.

EXHIBIT "A-1"

EASEMENT LEGAL DESCRIPTION

PARK EASEMENT DESCRIPTION

THE SOUTH 20 FEET OF THE NORTH HALF OF LOT 12 IN BLOCK 62, ACCORDING TO THE OFFICIAL MAP OF THE TACOMA TIDE LANDS, FILED IN THE OFFICE OF THE COMMISSIONER OF PUBLIC LANDS AT OLYMPIA, WASHINGTON, 3 SEPTEMBER 1895.



MICHAEL A. MCEVILLY, P.L.S.
WASHINGTON STATE REGISTRATION NO. 44639

SITTS & HILL ENGINEERS, INC.
4815 CENTER STREET
TACOMA, WASHINGTON 98409
TELEPHONE: (253) 474-9449

EXHIBIT "A-2"

EASEMENT AREA DEPICTION Park Easement

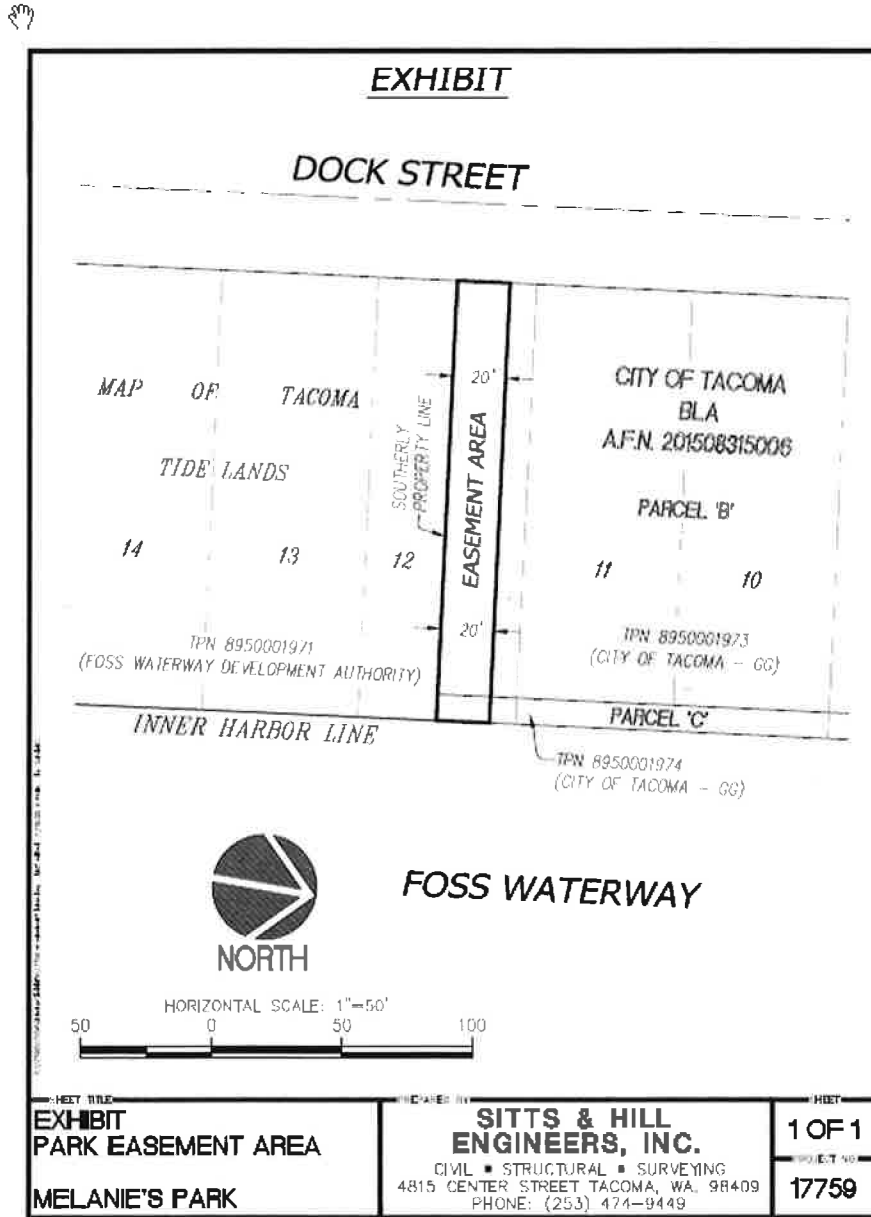

EXHIBIT "B-1" EASEMENT LEGAL DESCRIPTION

SEWER EASEMENT DESCRIPTION

↶

THE SOUTH 13.08 FEET OF THE WEST 12.50 FEET OF LOT 11 AND THAT PORTION OF THE WEST 12.50 FEET OF LOT 12 LYING NORTH OF THE SOUTH 20 FEET OF THE NORTH HALF THEREOF, ALL IN BLOCK 62, ACCORDING TO THE OFFICIAL MAP OF THE TACOMA TIDE LANDS, FILED IN THE OFFICE OF THE COMMISSIONER OF PUBLIC LANDS AT OLYMPIA, WASHINGTON, 3 SEPTEMBER 1895.



MICHAEL A. MCEVILLY, P.L.S.
WASHINGTON STATE REGISTRATION NO. 44639

SITTS & HILL ENGINEERS, INC.
4815 CENTER STREET
TACOMA, WASHINGTON 98409
TELEPHONE: (253) 474-9449

EXHIBIT "B-2"

EASEMENT AREA DEPICTION Sewer Easement

