

# Puyallup Avenue Corridor Conceptual Design

Infrastructure, Planning and Sustainability Committee  
October 25, 2017



# Project Goals

---

- Utilize the **entire ROW** for multimodal uses/complete street concepts
- Enhance the experience **for everyone**, including pedestrians, cyclists, drivers, transit riders and freight operators
- Achieve **subarea plan** goals
- Make Puyallup Avenue an **inviting space** where people want to visit

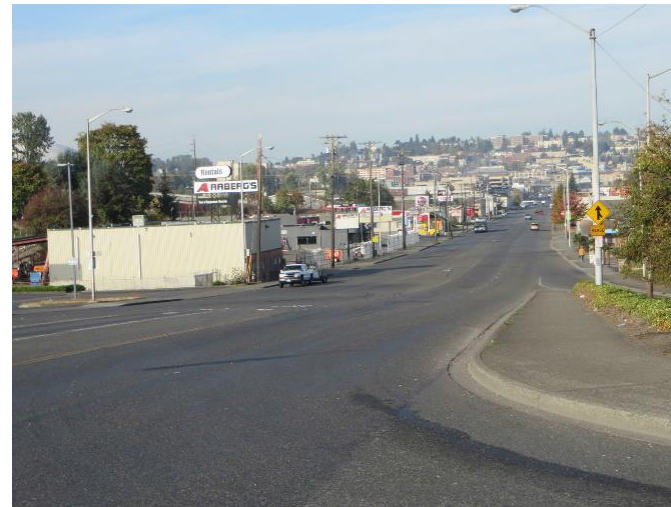

# Project Outreach



- October '16
  - Stakeholder Focus Groups (2)
  - In-Person Surveys (90 completed)
- November '16
  - Online Survey & Mapping Tool (212 responses)
  - Stakeholder Design Charrette/Site Walk
  - Public Design Charrette
- June '17 – Public Open House
- June/July '17 – Collected online feedback on alternatives
- Technical Advisory Meetings
  - September '16
  - November '16
  - May '17

# Project Outreach - Notifications

---

- Tacoma News Tribune
  - Online and print ads (for Nov. & June events, each ran twice)
- Banner on City Webpage (~10 days prior to each event)
- City of Tacoma News Release (one prior to each event)
- Promoted on 'What's Going On' City webpage and 'Tacoma Report' news program
- Email Blasts
- Social Media – Issued 22 posts Oct. '16 & July '17
  - Focused on Nov. 9 / June 5 events & June/July comment period
  - Facebook
    - 14,153 total feeds (post for June 5<sup>th</sup> Open House – 2,500 feeds, event viewed/clicked-on 754 times, 54 RSVP'd interested in attending)
  - Twitter
    - 27,055 total feeds
    - 441 liked/shared
    - 163 clicked on link
  - Website – 1,476 unique/1,842 total views; **Avg. time on page = 3min 13sec**

# Stakeholders/Businesses/Property Owners

## Puyallup Avenue

- Diamond Parking
- Rick/Jori Adkins (5 Properties/Businesses)
- Alfred's Café
- 304 Puyallup Avenue
- Wingman's Brewers
- Bulls Eye Indoor Range
- Summit Olympus School
- The Storage Box
- Seasons Travel/Tacoma Commercial Brokers
- Architectural Woods
- Industrial Tire
- Tacoma Dome Neighborhood Business District Members
- BNSF

## Tacoma Dome Area

- Western Builders Supply
- Freighthouse Square
- PJ Hummel and Company
- SuperValu

- Dome District Property Developers

- Celebrity Cakes

## Trucking Community

- Nichols Trucking
- Caraustar Industrial
- Life Express LLC
- Truck Rail Handling
- Tacoma Transload Trucking

## Agencies/Other

- UWT
- Puyallup Watershed Initiative
- Foss Waterway Development Authority
- Port of Tacoma
- Metro Parks
- Tacoma Wheelman
- Pierce Transit
- Sound Transit
- Downtown On The Go
- FWDA
- WSDOT Rail
- Amtrak



# What We Heard: Public Feedback

---

**In terms of transportation, what would make Puyallup Avenue more attractive to you?**

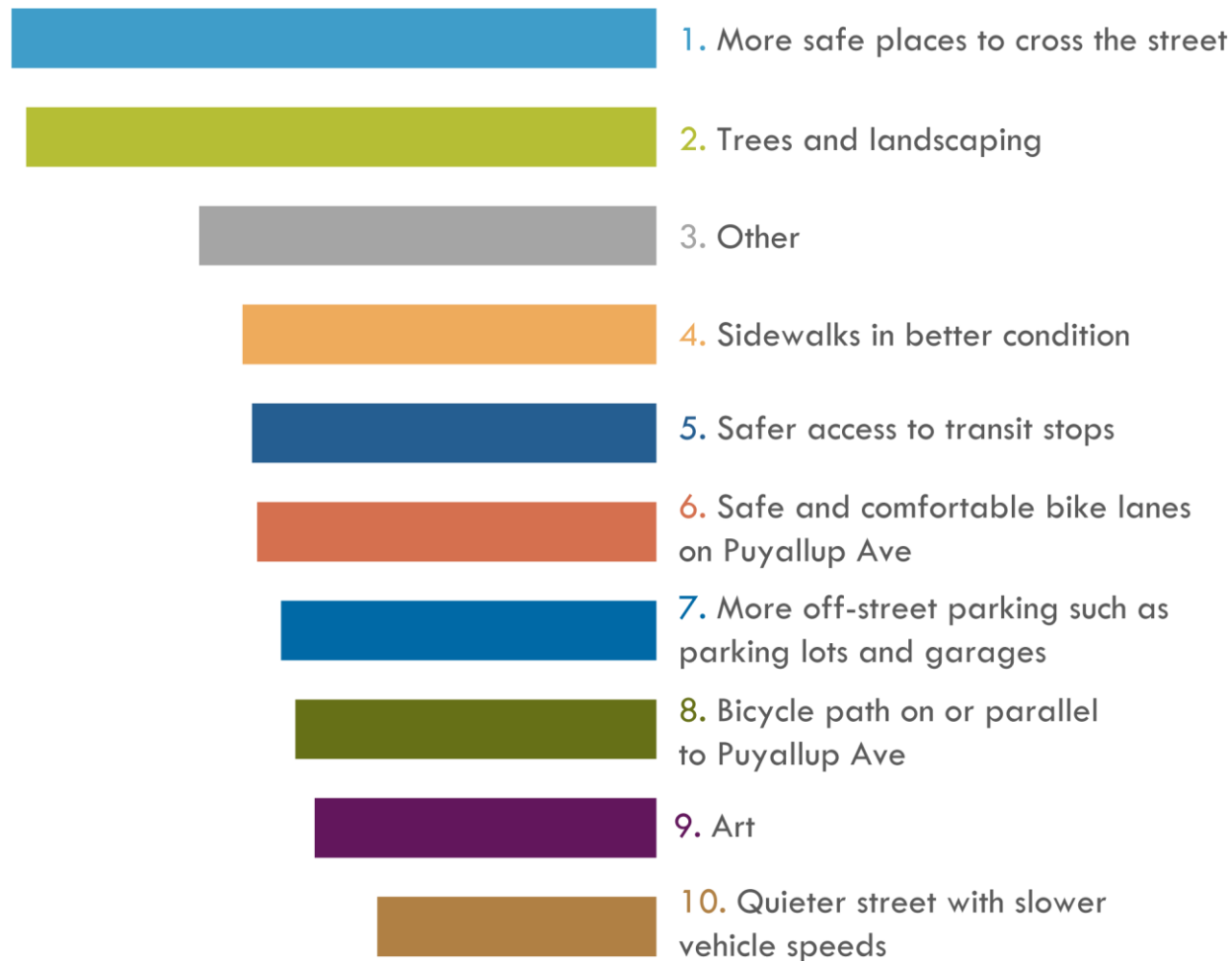

# What We Heard: Stakeholder Feedback

---

- Want **Subarea Plan** efforts to come to fruition
- Need **access to TDS**
- **Parking** is increasingly an issue
- Must be be **safer and more comfortable for pedestrians**, especially students
- Doesn't currently feel like a **safe street to bike**
- Preserve the **unique historic and industrial character**
- **Acts as a gateway** for people arriving in Tacoma by transit or for events
- **Make it feel like a place**



## PUYALLUP AVENUE CORRIDOR DESIGN

### Public Meeting

**Monday, June 5**

5 PM - 7 PM

Presentation at 5:30 PM

Summit Olympus School  
409 Puyallup Avenue  
Tacoma, WA 98421

The City of Tacoma is holding a public meeting to share proposed concepts for corridor improvements along Puyallup Avenue from Portland Avenue to South C Street. We hope you join us to share your comments on the design!

This project is meant to enhance the experience along the corridor for pedestrians, cyclists, drivers and transit riders. Possible improvements include landscaping, lighting, new sidewalks and crossings, bicycle improvements, enhanced transit facilities and other amenities.



### FOR MORE INFORMATION

For more information, visit [cityoftacoma.org/PuyallupAve](http://cityoftacoma.org/PuyallupAve) or contact Project Manager Mark D'Andrea at (253) 591-5518 or [mdandrea@ci.tacoma.wa.us](mailto:mdandrea@ci.tacoma.wa.us).



# Corridor Alternatives / Open House

# Puyallup Avenue – Existing Conditions

Puyallup Avenue between E. D St and E. E St facing East

Existing

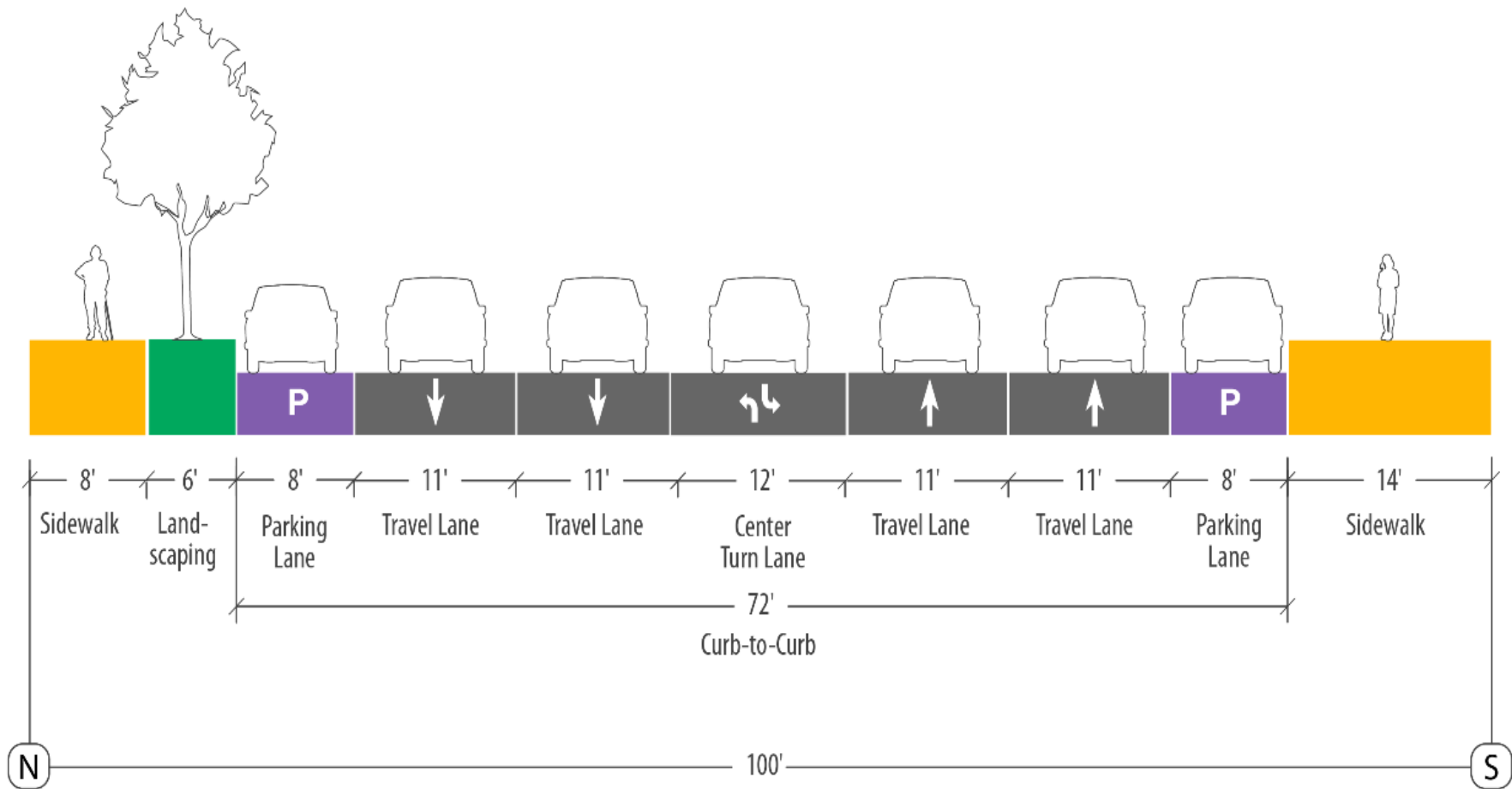

# Alternative 1: Bike Path, Transit/HOV Lane, 2 General Purpose Lanes + Center Turn Lane

Puyallup Avenue between E. D St and E. E St facing East

Alternative 1

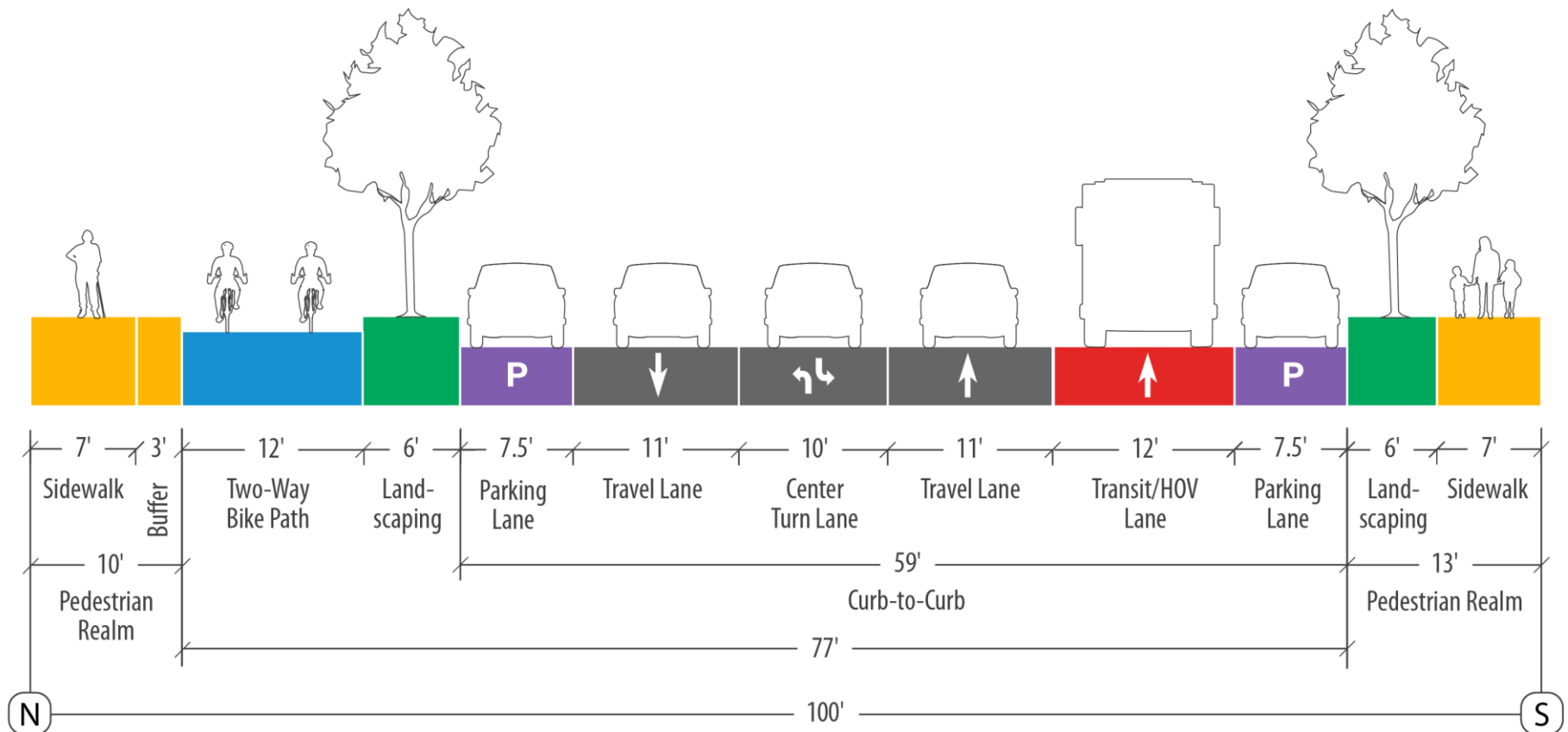

# Alternative 2: Protected Bike Lane with 4 General Purpose Lanes

Puyallup Avenue between E. D St and E. E St facing East

Alternative 2

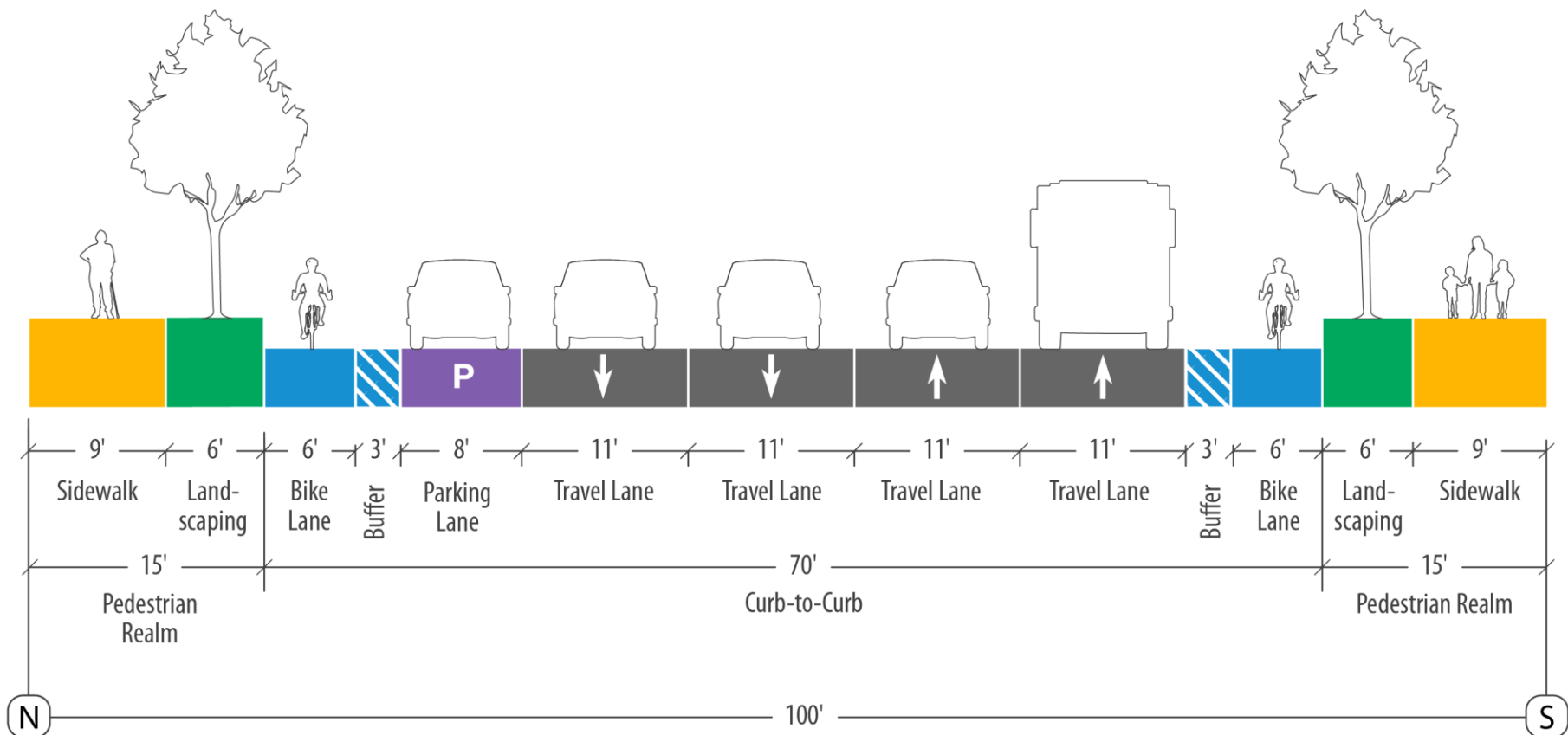

# Alternative 3: Buffered Bike Lanes with Two General Purpose Lanes + Center Turn Lane

Puyallup Avenue between E. D St and E. E St facing East

Alternative 3

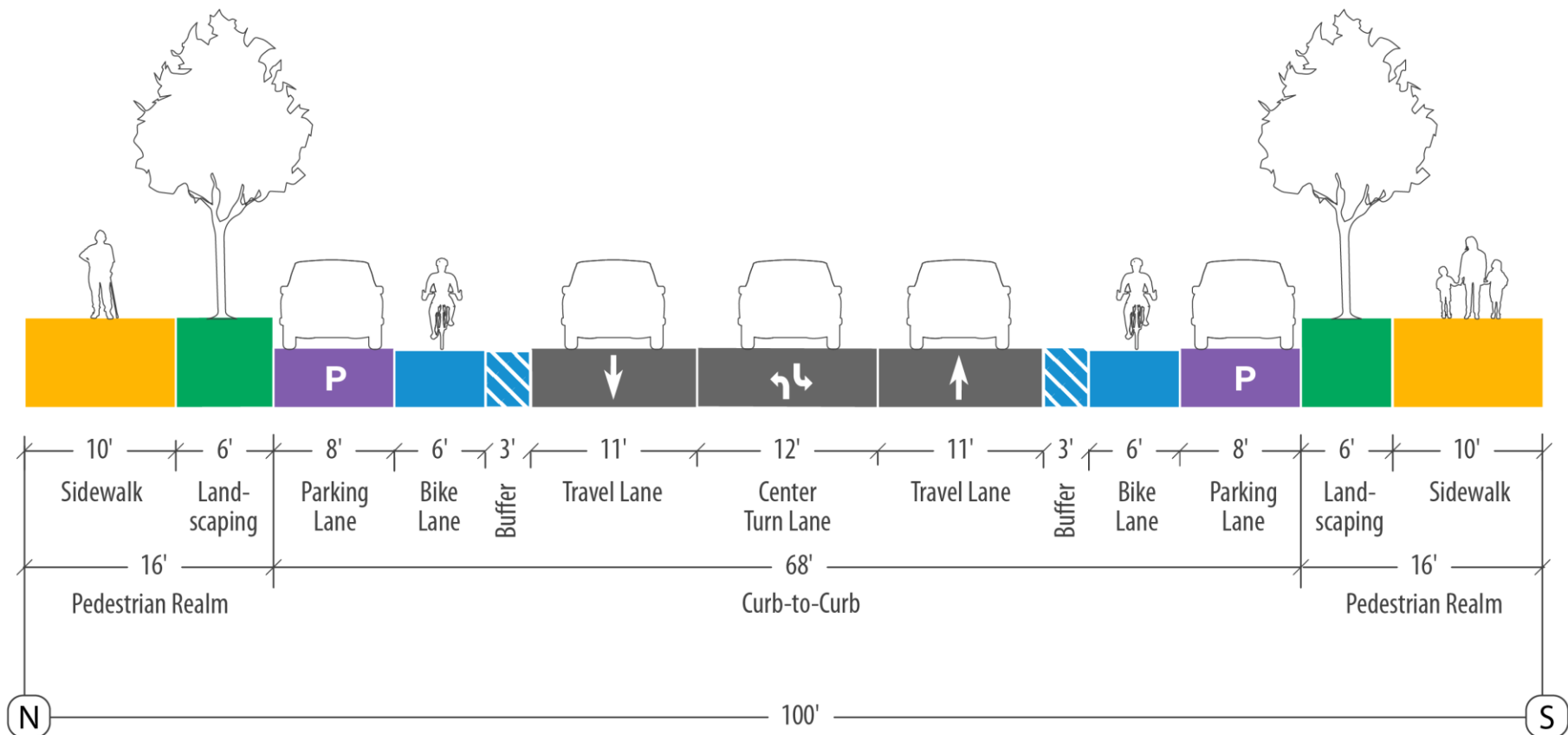

# Alternative Summary (2040)

Measure	No Build	Alt. 1	Alt. 2	Alt. 3
<b>Vehicle Lanes</b>	2-GPL each direction, CTL, parking both sides	1-GPL WB, CTL, 1-GPL & 1-HOV/transit EB, reduced parking	2 GPL each direction, reduced parking	1 GPL each direction, CTL, no change in parking
<b>% On-Street Parking Maintained</b>	100%	86%	80%	100%
<b>Bicycle Accomodation</b>	None	12' 2-way protected bike lane	6' protected bike lanes	6' buffered bike lanes
<b>Driving Travel Time</b>	4.6 min	6.8 min	5.2 min	7 min
<b>HOV Transit Time</b>		4.6-5.2 min		
<b>Two-Way Left Turn Lane</b>	Yes	Yes	No	Yes
<b>Sidewalk Width</b>	7-14 feet	10-14 feet	9-15 feet	6-16 feet
<b>Ped Buffer from Traffic</b>	0-10 feet	7-29 feet	15-23 feet	15-23 feet

# Open House Summary

---

- Alt. 1 generally preferred, but support provided for:
  - Protected bike lanes (Alt. 2)
  - Parking management/reduced on-street parking (Alt. 2)
  - Wide sidewalks/separation from traffic (Alt. 3)
- Concerns: Reduced lanes/turning queues, landscaping maintenance, ped/bike-friendly protective environment
- Hybrid alternative developed (Alt 4)



# Hybrid Alternative 4

**Puyallup Avenue between Pacific Ave and A St facing East**  
Alternative 4

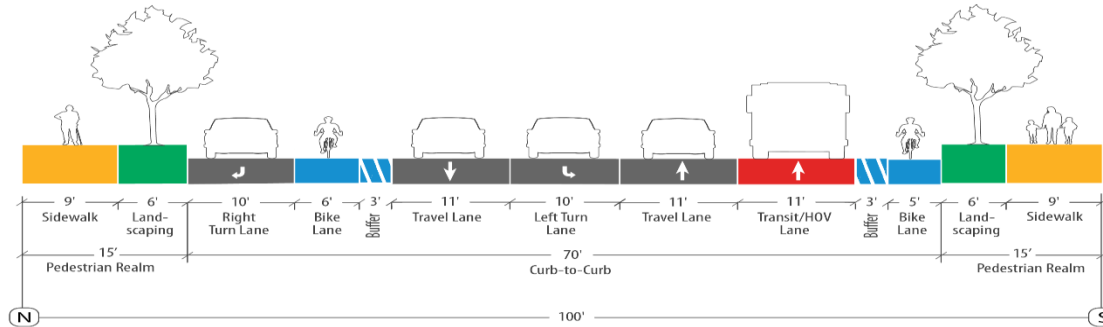

**Puyallup Avenue between E. D St and E. E St facing East**  
Alternative 4

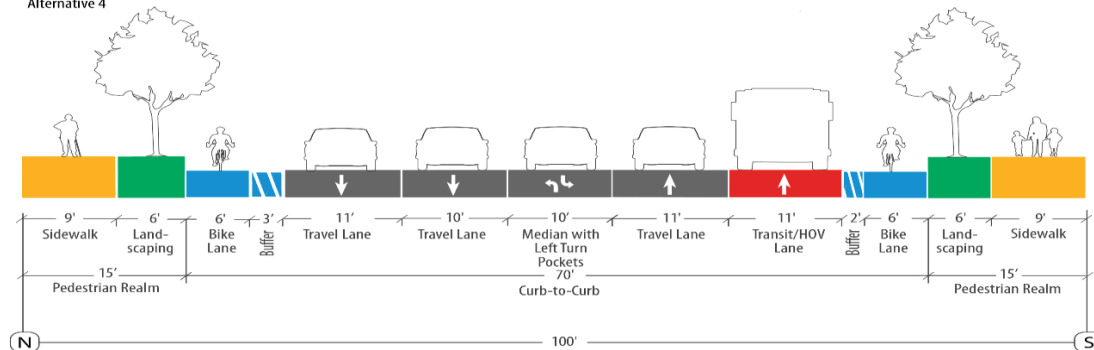

**Puyallup Avenue between E. K St and E. M St facing East**  
Alternative 4

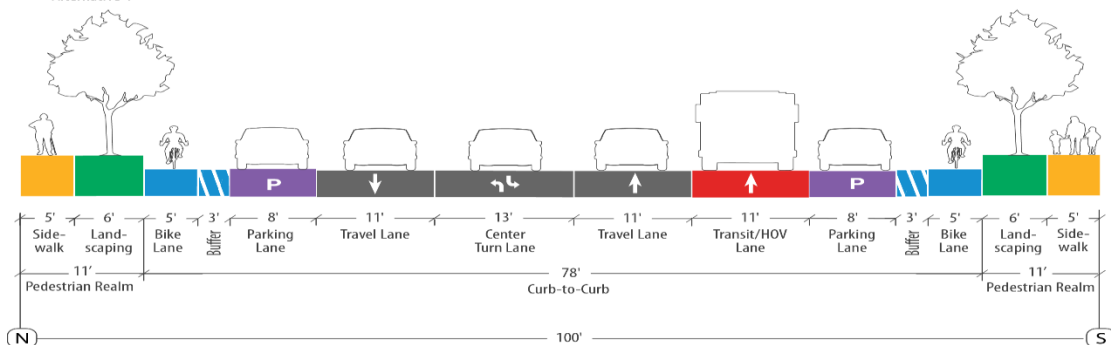

# Puyallup Avenue from East D Street to East E Street

## Plan View – Alternative 4

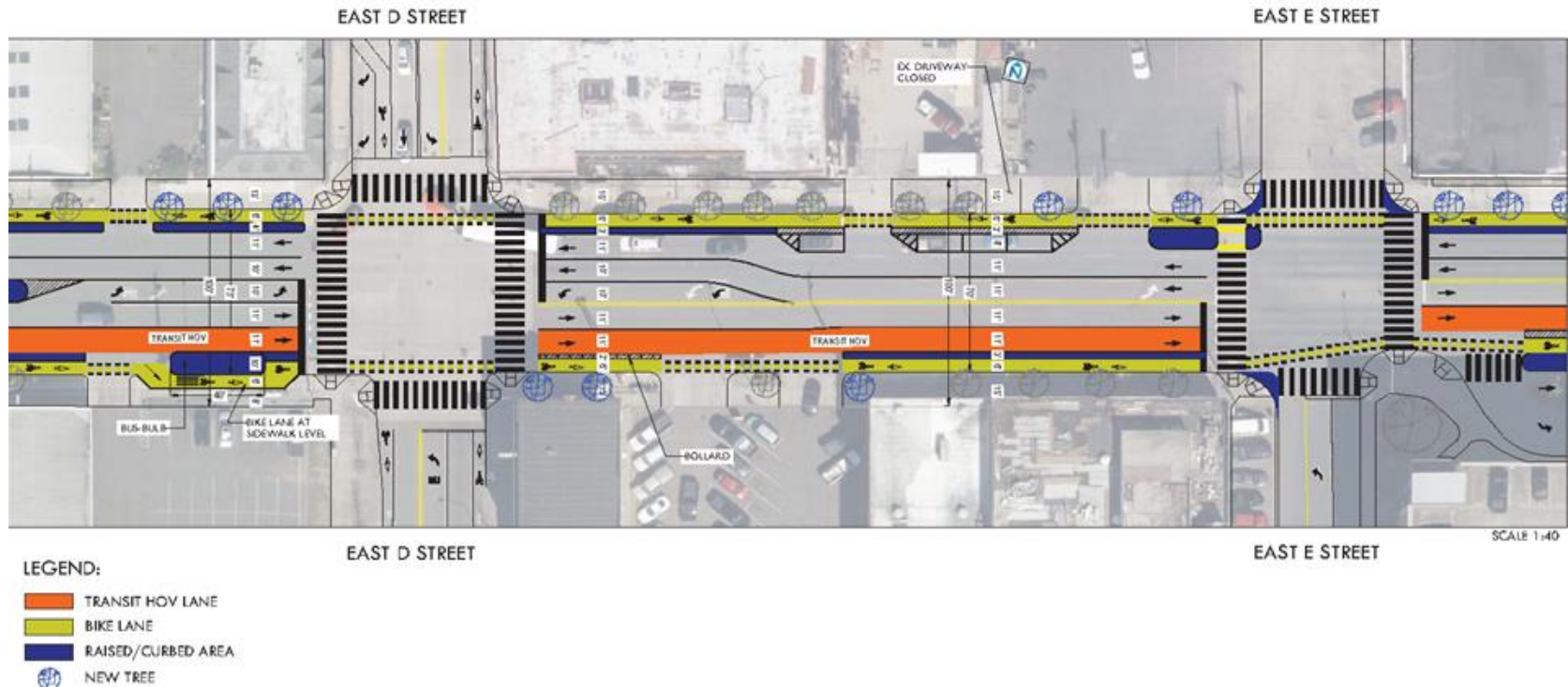

# Next Steps

---

- Coordinate with ST/PT Studies for Light Rail, Link and HCT (~18 months)
- Update Puyallup conceptual plan/address use of parallel corridors (E. 25<sup>th</sup>/26<sup>th</sup> St.)
- Obtain public comment

# Thank You!



# Transit's Preferred WB Route

