



Waterfront Update:

City of Tacoma | Community & Economic Development Department

Economic Development Subcommittee

February 27, 2018

ITEM #18-0177





Overview



- Destination Point Defiance is a long-term comprehensive planning initiative started years ago to enhance the park's experience and honor its character.
- The capital improvement bond approved by voters in 2014 is funding much of the related construction work along with grants from the state RCO program, Washington State taxpayers, donors and other sources.

Keeping Promises



- Point Defiance Park is open!
- Coordinating activities to maintain positive visitor experiences
- Metro Parks is delivering what it promised in the 2014 bond



• • • Environmental Learning Center

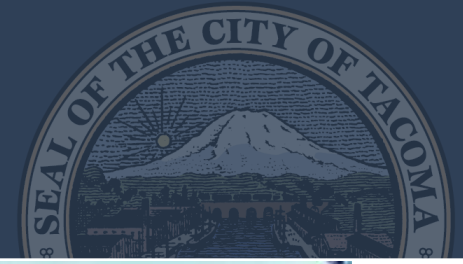

• Now Open!

● ● ● Environmental Learning Center



••• Pacific Seas Aquarium



Opening
mid-2018



• • • Pacific Seas Aquarium



32-foot
curved
window for
an amazing
unobstructed
view

●●● Pacific Seas Aquarium

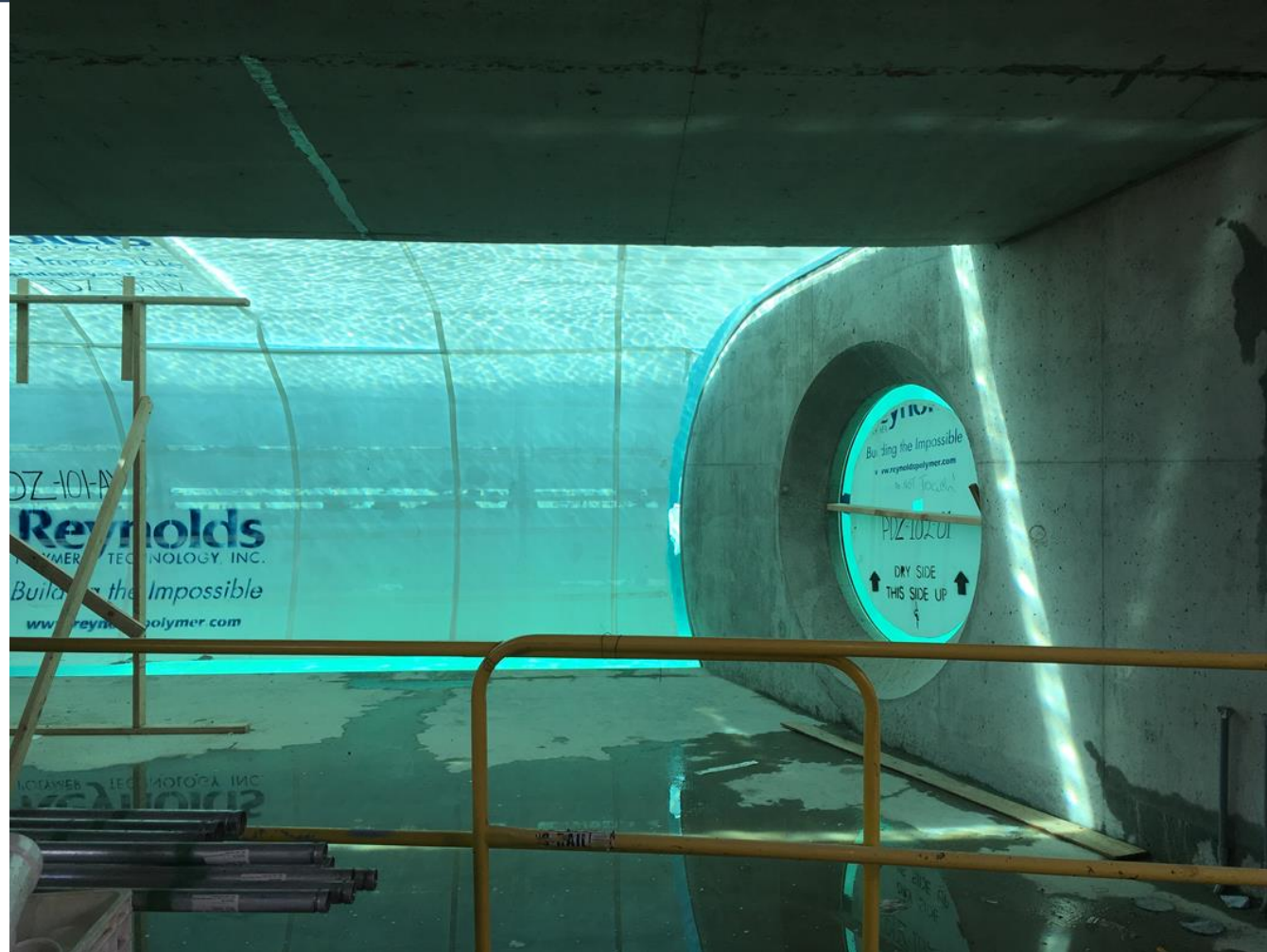

••• Pacific Seas Aquarium



Main tank: 250,000 gallons

••• Pacific Seas Aquarium

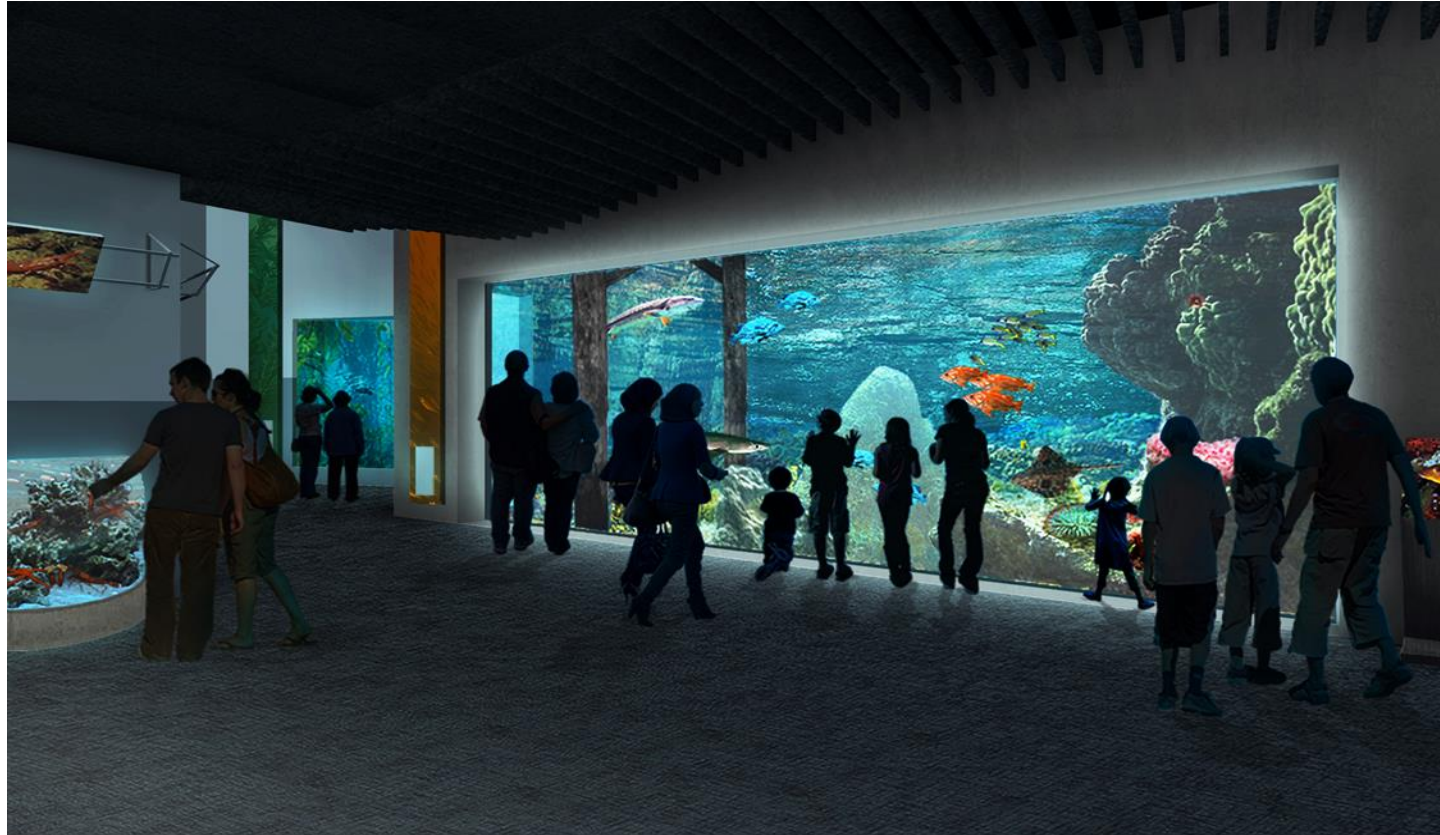

Hammerheads, turtles, rays & more!

Waterfront Phase I



Major Benefits:

- Better parking for boat trailers & park users
- 11-acre park on the peninsula
- Trail & bridge linking Ruston Way with Point Defiance
- Slides!





Point Ruston/Ruston Way

Multi-Purpose Parking Lot

Wilson Way

Pedestrian Path

Tacoma Yacht Club

Dune Peninsula







● ● ● Pearl St. Entrance

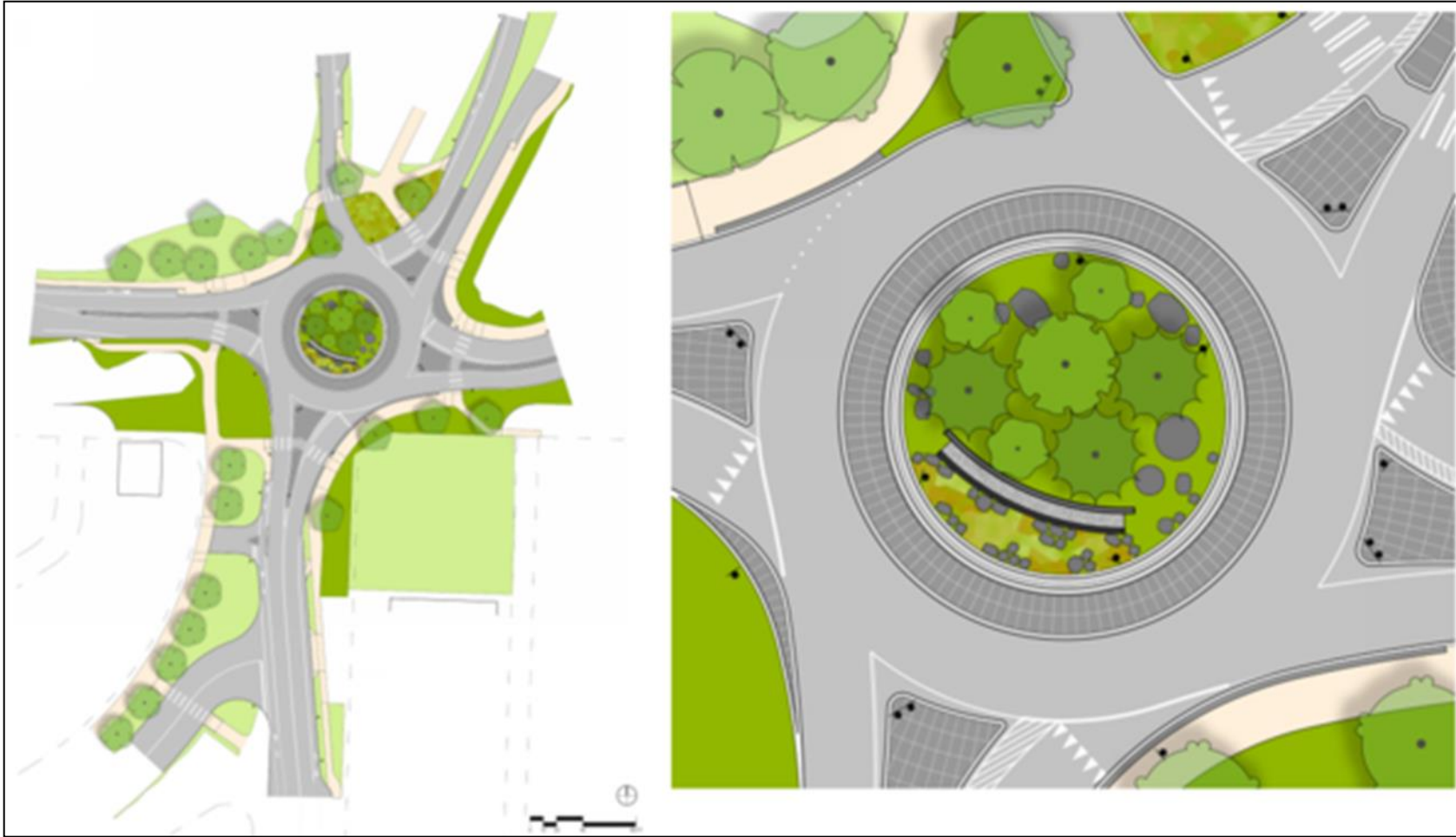

●●● Pearl St. Entrance



 Stay Updated!



DestinationPointDefiance.org

WATERFRONT
PENINSULA >

ZOO
PROJECTS >

TRAFFIC & PARKING >

ROUNDBOUT >

OTHER PROJECT
AREAS >

MASTER PLAN >

CONTACT US >



SIGN UP
FOR EMAIL
UPDATES

Special Events



Collective Priorities



- Improve the experience for event producers working in Tacoma.
- Partnership with stakeholder groups and agencies to recruit and secure regional and national events.





Envision Tacoma's Waterfront



- Joint Initiative to develop a community vision to improve access to the waterfront
- Improve safety and access
- Prioritize infrastructure improvements
- Work with the public, partner organizations and the business community





● ● ● Downtown to Defiance Trolley

- *A partnership enhancing our economic vitality*



●●● SERVICE IMPROVEMENTS



- Supports tourism & economic development
- Access to community destinations from Downtown Tacoma to Point Defiance
- More connections to other transportation services & easier parking for riders



OVERVIEW



Proposed 2018 Downtown to Defiance Trolley Pilot Season

- June 1, 2018 – September 2, 2018
- Trolley service operates Friday – Sunday
- Trips every 30 minutes from 10 am – 9 pm
- Fare is \$1 per ride, or \$5 for All-Day Pass



IMPROVED ACCESS

- Route extended along Pacific Avenue to 26th St.
- Serves all Downtown Museums
- Service into Point Ruston
- Same route at Point Defiance
- Connections at Tacoma Dome Station to other transportation options & parking

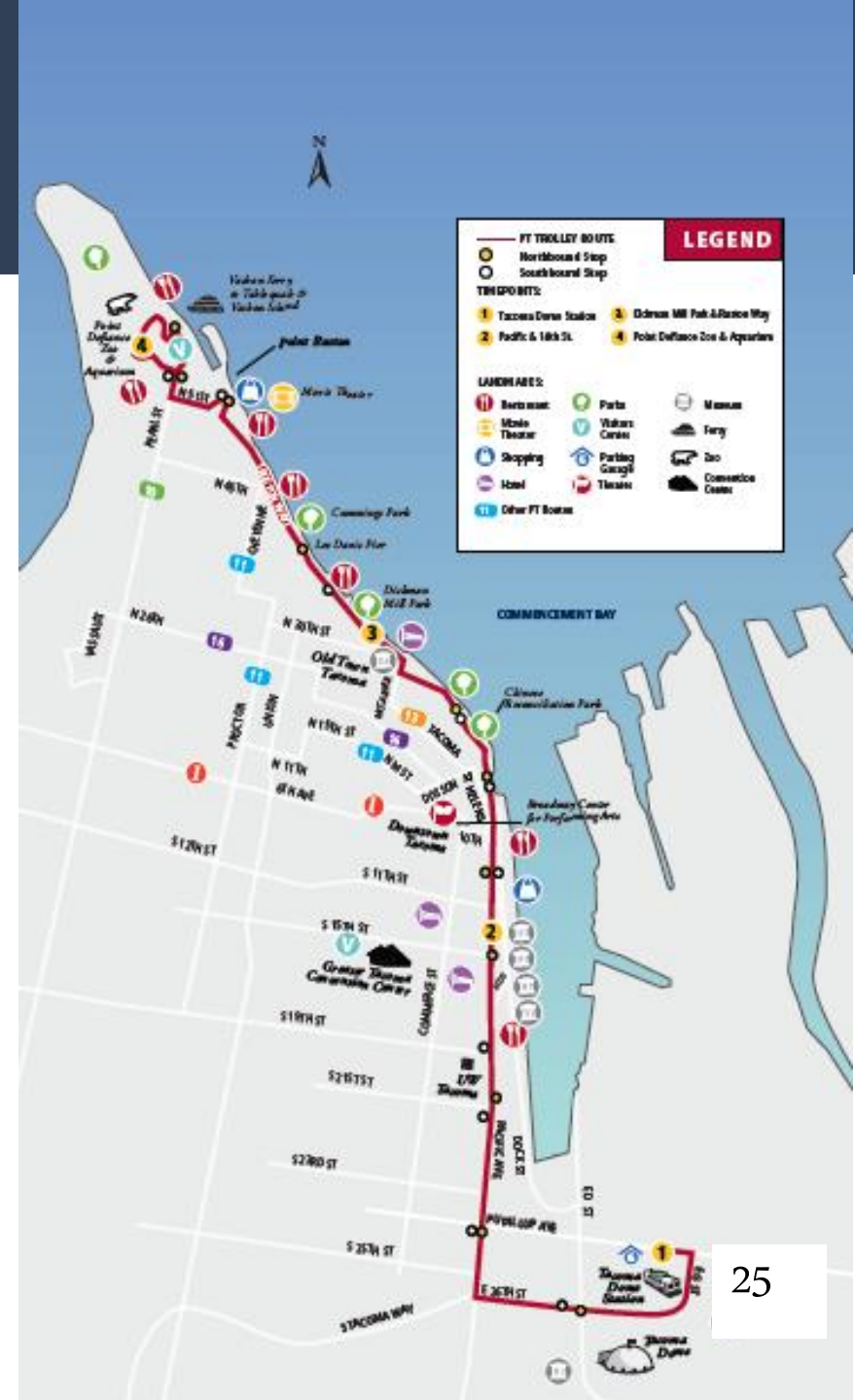

PARTNERSHIPS



	<u>Partnership</u>
Pierce Transit	\$149,084
City of Tacoma	\$ 67,000
Metro Parks	\$ 25,000
Point Ruston	\$ 25,000
Travel Tacoma	<u>\$ 5,000</u>
2018 Service Estimate	\$266,084

ECONOMIC ENGAGEMENT



- **Hotel Partnerships**

- Developing partnership for free rides for hotel guests

- **Museum Partnership**

- Working with museums to identify coordinated promotional opportunities

- **Community Engagement**

- Fairs & Events: Farmer's Market Outreach, Bike Swap
- Transit to Trails: Chinese Reconciliation Park
- Engage Business District & Neighborhood Groups
- Social Media & Other Promotions





NEXT STEPS



- Partner Agreements approved by April 30, 2018
- Coordination with City of Tacoma on new temp. bus stops
- Coordination with museums & hotels
- Ongoing education & outreach



Waterfront Update:

City of Tacoma | Community & Economic Development Department

Economic Development Subcommittee

February 27, 2018

ITEM #18-0177

